

A B C D

DO NOT SCALE IF IN ANY DOUBT-ASK

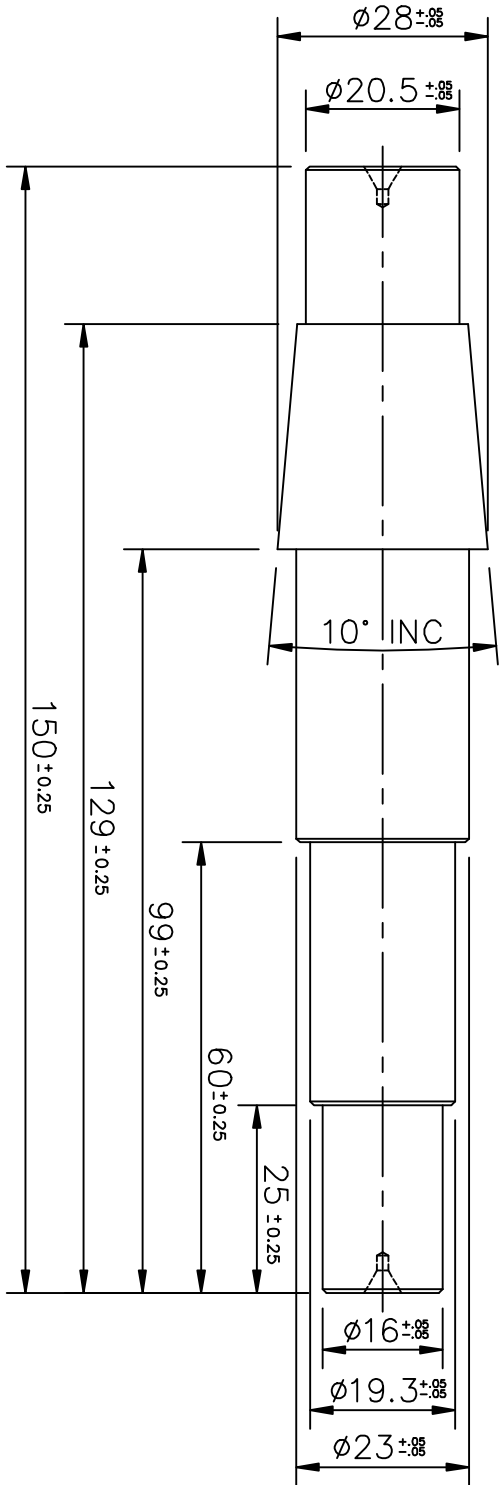
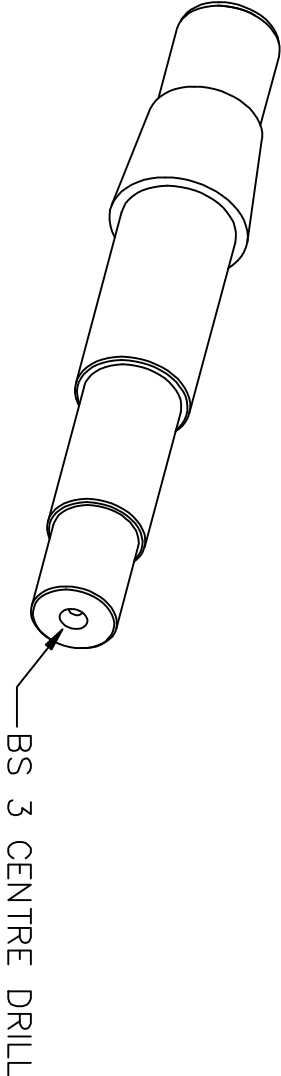

$\sqrt{\text{ }}$ SURFACE FINISH $1.6 \mu\text{M}$

\odot CONCENTRICITY 0.1

∇ TOTAL RUNOUT 0.1

ALL CHAMFERS 0.5 @ 45°

"Note 1" - Shaft to be made from Practice Shaft

TTE Training Tomorrow's Engineers
www.tteftd.co.uk

| PROJECTION | | NAME | | TAPERED SHAFT | | TOLERANCES | | DESCRIPTION | |
|-------------------|--|---------------|--|---|--|--|--|------------------------|--|
| PART No | | T1-0034-01-01 | | DIMENSIONS TO ONE DECIMAL PLACE (0.0) $\pm 0.10\text{mm}$ | | DIMENSIONS TO TWO DECIMAL PLACES (0.00) $\pm 0.025\text{mm}$ | | TAPERED SHAFT | |
| MAT'L | | See Note 1 | | ALL OTHER DIMENSIONS $\pm 0.5\text{mm}$ UNLESS STATED | | ANGULAR DIMENSIONS $\pm 0.5^\circ$ | | PHASE 1 ROA MODULE MS4 | |
| FINISH | | FINE TURNED | | DRAWN E.CODY | | DATE | | 9-10-07 | |
| No OFF | | 1 OFF | | SCALE 1:1 | | SHEET 1 of 1 | | REV 5 | |
| REPORT ANY ERRORS | | | | CHKD | | DWG No | | T1-0034-01-01A4 | |