

Installation Instructions For Cable Gland Types CW

FOR DIRECT ENTRY INSTALLATION - PLEASE READ ALL INSTRUCTIONS CAREFULLY BEFORE BEGINNING THE INSTALLATION

It is not necessary to dismantle the cable gland any further than illustrated below

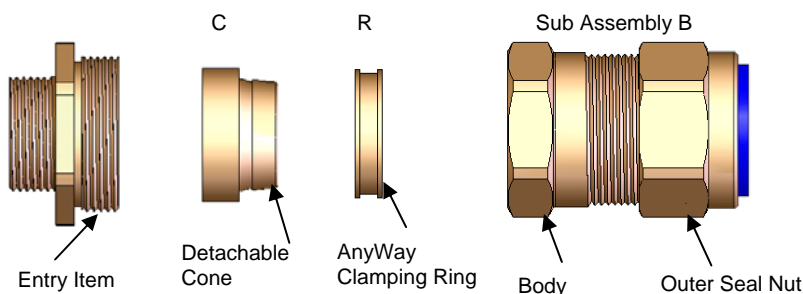

1. If required fit shroud over the cable outer sheath. Prepare the cable by removing the cable outer sheath and the armour to suit the geometry of the equipment. Remove a further 18mm (maximum) of outer sheath to expose the armour. If applicable remove any tapes or wrappings to expose the cable inner sheath. Separate the cable gland entry component from sub-assembly B. Ensuring that the outer seal is relaxed, pass sub-assembly "B" over the cable outer sheath and armour followed by the "AnyWay" clamping ring (R).

Note: On maximum size cables the clamping ring may only pass over the armour.

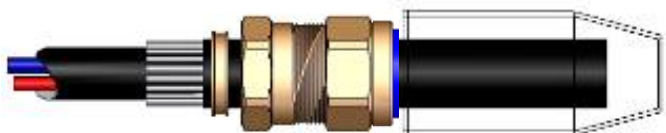

2. Secure the entry component into the equipment as indicated.

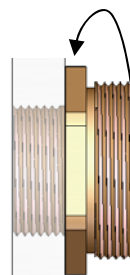

3. Locate the detachable armour cone (C) into the recess of the entry component. Pass cable through entry component evenly spacing the armour around the cone.

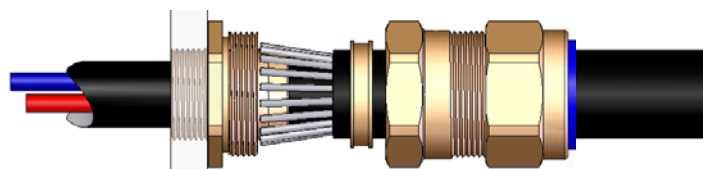

4. Whilst continuing to push the cable forward to maintain the armour in contact with the cone tighten the body of sub-assembly B onto entry component (as illustrated below).

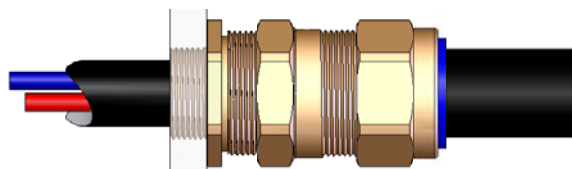

5. Ensure the two components make "metal to metal" contact.

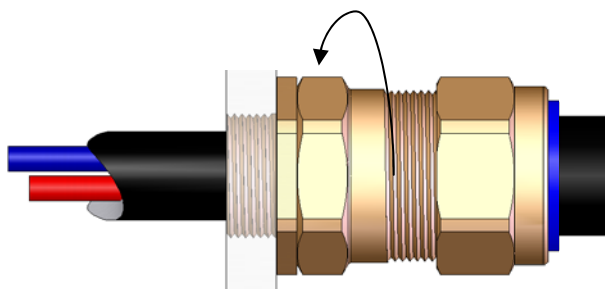

6. Tighten the outer seal nut until either:
i) the outer seal nut makes metal to metal contact with the gland body, or
ii) the outer seal nut has clearly engaged the cable and cannot be further tightened without the use of excessive force by the installer.

This completes the procedure for direct entry installation.
Please see overleaf for remote installation

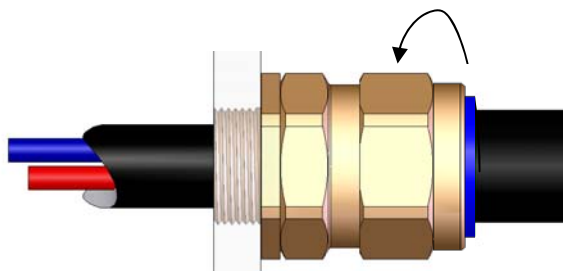

Document Reference: FI 228 Issue 3 06/07



CMP Products

Glasshouse Street, St Peters, Newcastle Upon Tyne, NE6 1BS

Tel: +44 191 2657411 Fax: +44 191 265 0581

E: cmp@cmp-products.com

Web: www.cmp-products.com

Installation Instructions For Cable Gland Types CW

FOR REMOTE INSTALLATION - PLEASE READ ALL INSTRUCTIONS CAREFULLY BEFORE BEGINNING THE INSTALLATION

1. If required fit shroud over the cable outer sheath

Prepare the cable by removing the cable outer sheath and the armour to suit the geometry of the equipment. Remove a further 18mm (maximum) of outer sheath to expose the armour. If applicable remove any tapes or wrappings to expose the cable inner sheath. Separate the cable gland entry component from sub-assembly B. Ensuring that the outer seal is relaxed, pass sub-assembly "B" over the cable outer sheath and armour followed by the "AnyWay" clamping ring (R).

Note: On maximum size cables the clamping ring may only pass over the armour.

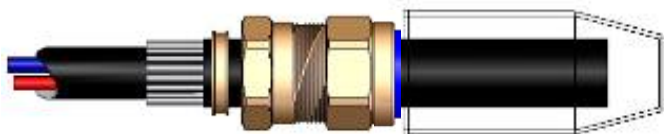

2. Locate the detachable armour cone (C) into the recess of the entry component. Pass cable through entry component evenly spacing the armour around the cone.

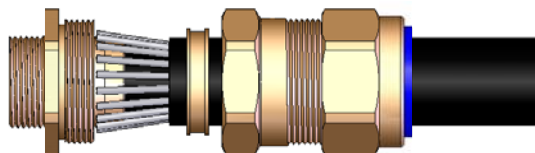

3. Hold the entry component, and whilst continuing to push the cable forward to maintain the armour in contact with the cone tighten the body of sub-assembly B onto entry component ensuring the two components make metal to metal contact.

For clearance hole installation secure gland with locknut and serrated washer, if required.

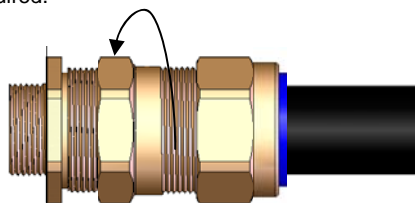

4. For threaded entry holes it is necessary to disconnect sub-assembly "B" from the entry component. Secure entry component into the equipment as indicated

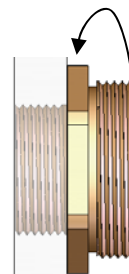

5. Pass the cone and cable assembly through the entry component.

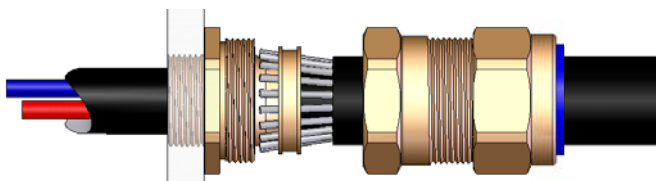

6. Hold the entry component, then re-tighten sub-assembly "B" ensuring the two components are fully tightened.

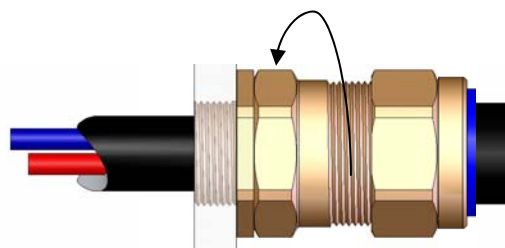

7. Tighten the outer seal nut until either:

- i) the outer seal nut makes metal to metal contact with the gland body, or
- ii) the outer seal nut has clearly engaged the cable and cannot be further tightened without the use of excessive force by the installer.

This completes the procedure for remote installation.

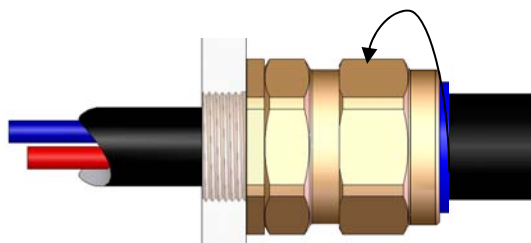

Document Reference: FI 228 Issue 3 06/07



CMP Products

Glasshouse Street, St Peters, Newcastle Upon Tyne, NE6 1BS

Tel: +44 191 2657411 Fax: +44 191 265 0581

E: cmp@cmp-products.com Web: www.cmp-products.com